

## QUICK GUIDE

# Cloud Based Student Computer Labs

### Content

1. INTRODUCTION.....	1
2. STEP 1 – INSTALL CITRIX WORKSPACE APP.....	1
3. STEP 2 – LOG IN TO LTU-PORTAL.....	2
4. STEP 3 – LOG OUT.....	3
5. OPEN, USE AND SAVE YOUR DATA .....	4

## 1. Introduction

Cloud Based Computer Labs makes it possible to use all education applications from any Student Computer Lab computer and from students own computers. The applications are executed at Microsoft Azure Data Center. It is therefore possible to use graphical demanding applications on thin clients and other kind of computers without expensive processors and graphical cards.

This quick guide is divided into four categories. For more details, please look in the full User Guide.

- STEP 1 – Install Citrix Workspace App
- STEP 2 – Login to LTU Portal
- STEP 3 – Log out

## 2. STEP 1 – Install Citrix Workspace App

- Click on any of the following links to start download the Citrix Workspace App

**Windows computer:** <https://www.citrix.com/downloads/workspace-app/windows/workspace-app-for-windows-latest.html>

**Mac computer:** <https://www.citrix.com/downloads/workspace-app/mac/workspace-app-for-mac-latest.html>

**Linux computer:** <https://www.citrix.com/downloads/workspace-app/linux/workspace-app-for-linux-latest.html>

- Click on the download button to start download

Download Citrix Workspace app for Windows

- When the download has finished, start the installation by a click on the file
  - Click on **Start** to start the installation
  - **Check the box** at the license agreement and click **Next**
  - **DO NOT** select **App Protection** checkbox. Click **Install**
  - Click on **Finish**

### 3. STEP 2 – Log in to LTU-portal

- Open a web browser and type in: <https://ltuportal.cloud.com>

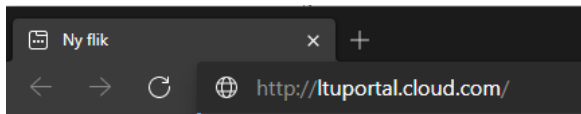

- Login using **either your e-mail** address and password **or your username** and password:
  - E-mail example: [student-9@student.ltu.se](mailto:student-9@student.ltu.se)
  - Username example: LTUAD\student-9
- After you are successfully logged in, you will be presented a page like this.

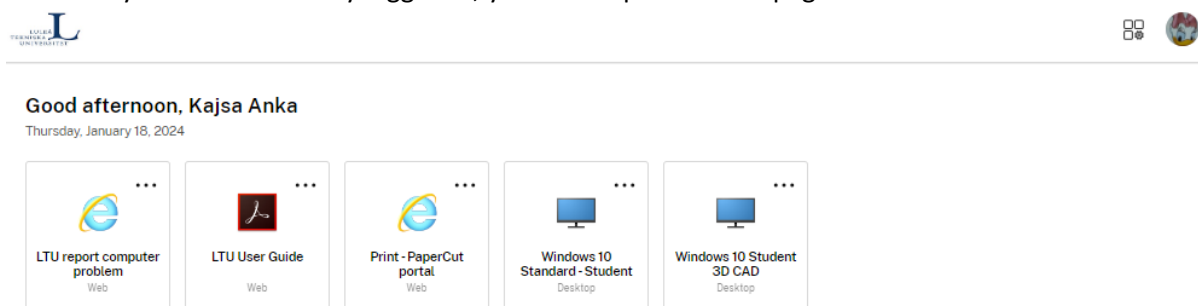

To **Start** a **desktop**, simply **click on it**

When your desktop has started it looks and works like a normal Windows PC. Applications could be found under the start menu.

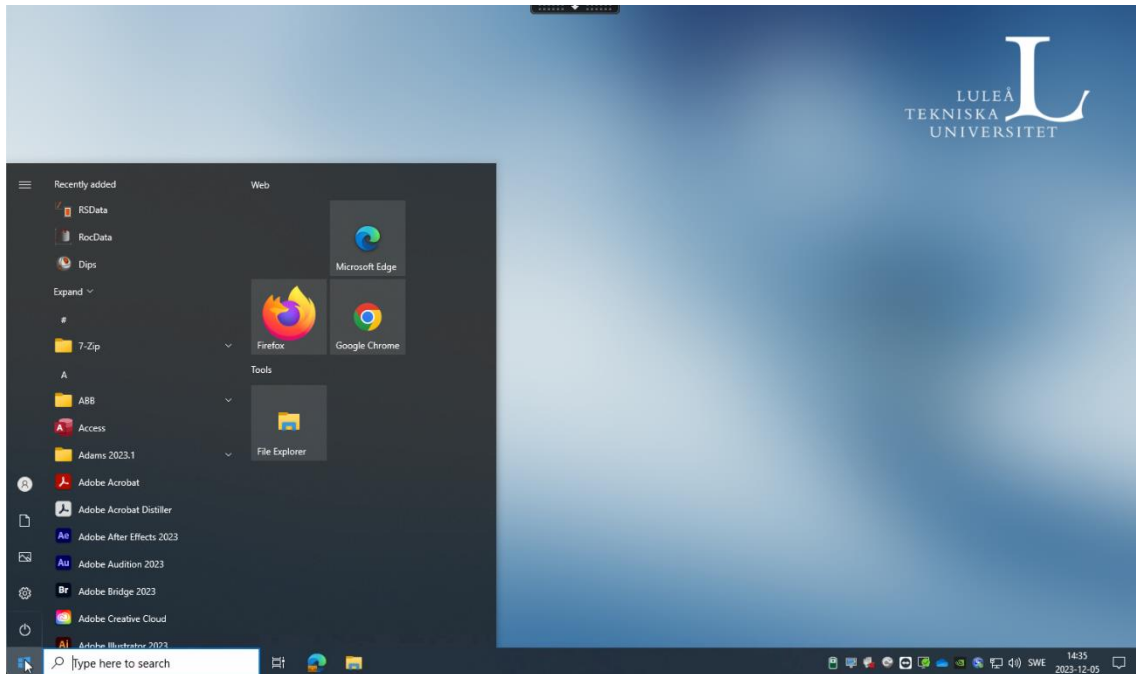

#### 4. STEP 3 – Log out

When you have finished working and want to log out of the desktop, press Start, then your user and finally Sign out.

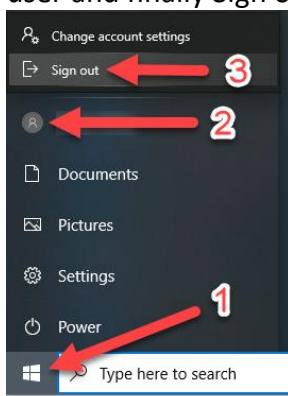

To restart the desktop, just click it again. If you are ready for the day, log out of the LTU portal by clicking on your username in the upper right corner and select Log Out.

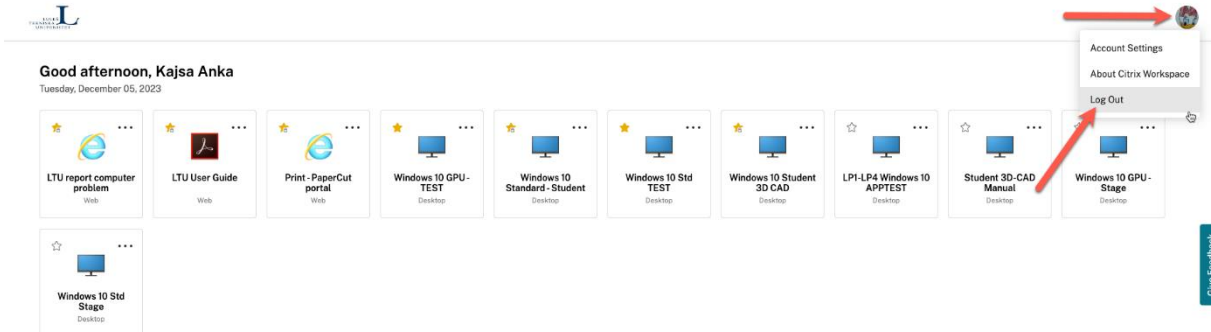

## 5. Open, use and save your data

To **store your materials** in a safe place we recommend **using OneDrive** because you can then access it anywhere and not just only in the cloud based desktops.

- Once logged in to your desktop you will find OneDrive in File Explorer.

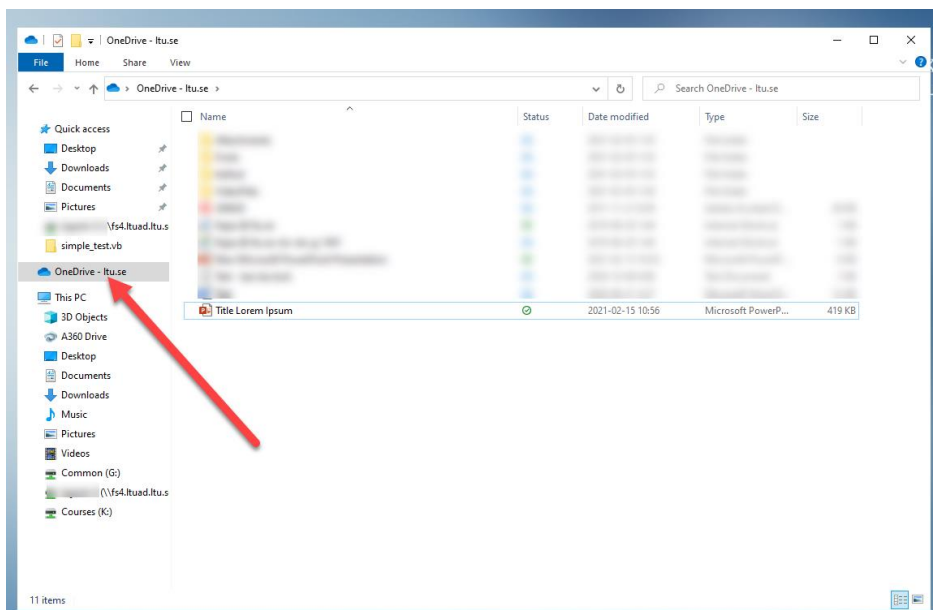

- It is **also possible** to store your materials **on the H-drive** (also available in local lab computers) but the **transfer speed** to and from this drive will be **significantly lower** than using OneDrive.

